



PICTURESMITH **STUDIO**

# THE STUDIO

Our basement studio is ideal for stills, packshots and stop motion shoots.

The largest shooting area is easily separated into two blacked-out stage areas.

Our art department is designed to help you finalise artwork for your shoot.

We are close to Broadway Market's restaurants, bars and coffee shops.

## Studio includes

- 2 x stage areas
- Work space with a large table and whiteboard
- Art department space
- Kitchenette
- WiFi
- Electrical Supply: 2x32amp 3-phase socket and multiple 13amp sockets
- Blackout drapes

Please note, we don't have lift access, and we are not a sound stage.

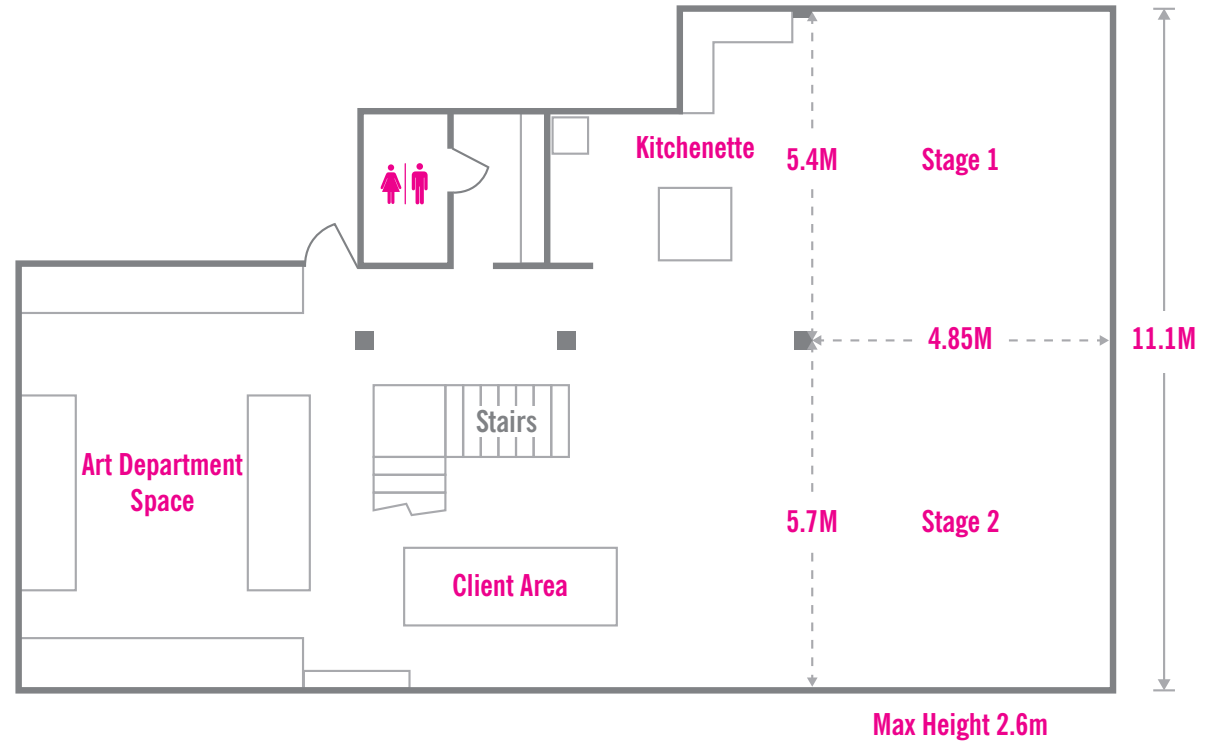

## Green Shoots

To ensure our carbon footprint is as small as possible, we use 100% renewable energy. We are also carbon balanced by **Tree Nation** and members of **1% For The Planet**.

In addition, we arrange for **Quantum Waste** to handle all recycling, food and other waste.

You can be confident that your shoot is as green as possible.







PICTURES MITH

PICTURES MITH

# RATE CARD

Studio (10 + 1 hrs)	£850 p/d
Prep day (8 + 1 hrs)	£600 p/d
Overtime	£80 p/h
Overtime after midnight	£160 p/h
Studio manager O/T	£30 p/h
Studio manager O/T after midnight	£60 p/h
Electricity as used	

(Weekends available on request)





**ART DEPARTMENT SPACE**

# HOW TO FIND US

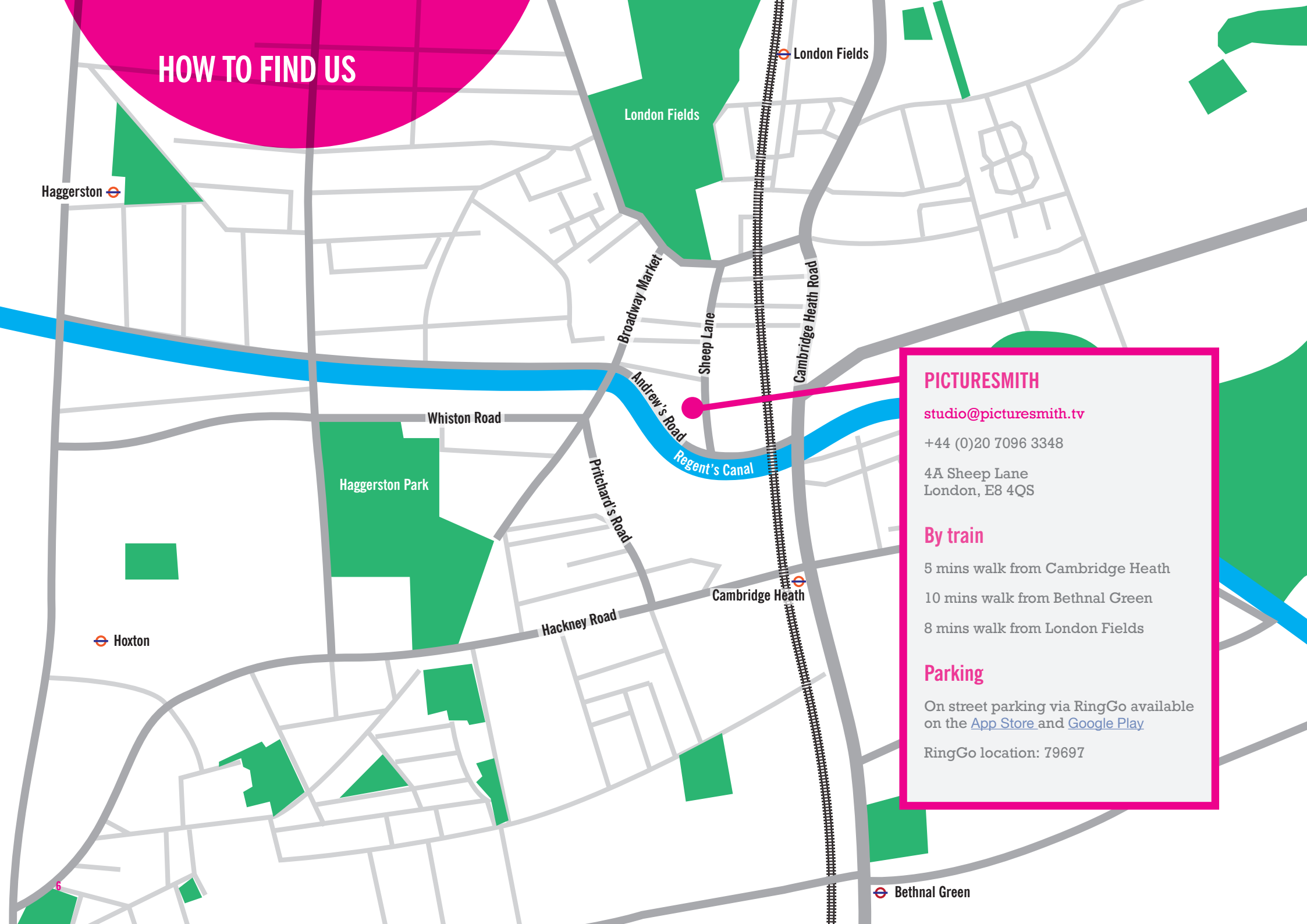

## PICTURESMITH

studio@picturesmith.tv

+44 (0)20 7096 3348

4A Sheep Lane  
London, E8 4QS

### By train

5 mins walk from Cambridge Heath

10 mins walk from Bethnal Green

8 mins walk from London Fields

### Parking

On street parking via RingGo available  
on the [App Store](#) and [Google Play](#)

RingGo location: 79697